

ANGUS & DUNDEE GARDENS 2020

Scotland's
GARDENS
Scheme
OPEN FOR CHARITY

**INCLUDING THE
ANGUS & DUNDEE
GARDEN TRAIL**

[SCOTLANDSGARDENS.ORG](https://scotlandsgardens.org)
Scottish Charity No: SC011337

YOUR ISSUES MAKE OUR ISSUES



As the world shrinks with new and faster means of communication, what is happening on your doorstep has never been more important. Every day in The Courier you will find local news, sport and features that impact on you. At The Courier we believe that local matters.

Local Matters

THE COURIER

ANGUS & DUNDEE GARDEN TRAIL

Running over the Thursdays, Fridays and Saturdays in June, the Angus & Dundee Gardeners are offering an opportunity to visit 17, not previously opened, gardens across Angus and Dundee.

Our trail offers a flexible way to keep up your weekly dose of beautiful gardens, and excellent value for money. These gardens are all new to SGS and run from the west end of Dundee to the coast around Arbroath, over through Forfar to Edzell and down to Meigle. Visit a community garden, productive walled garden, as well as 13 further private gardens of varying sizes and styles. The Dundee Botanic Garden will promote the trail with entry to trail ticket holders over the first weekend. Maggie's Dundee garden will also be available to visit throughout the trail.

**A ticket for the
Angus & Dundee Garden Trail
makes a perfect gift,
and treat yourself as well!**

CHARITY

Sixty percent of the proceeds will go to Maggie's Dundee with the net remaining proceeds to the SGS beneficiaries: The Queen's Nursing Institute Scotland, Maggie's and Perennial.

Maggie's cancer care charity provides free practical, emotional and social support to people with cancer and their family and friends, following the ideas about cancer care originally laid out by Maggie Keswick Jencks. Built in the grounds of Ninewells Hospital, Maggie's Dundee is a place with professional staff on hand to offer the support people need: providing practical advice, emotional support, a place to meet other people, and somewhere you can simply sit quietly with a cup of tea.

ADMISSION

£25 for entrance to all gardens (with £20 early bird price before 1 May). Accompanied children free. Pre-sale tickets available online at Eventbrite (search Angus & Dundee Garden Trail 2020) or from the local SGS committee members. Tickets otherwise available on the day at the gardens. Gardens can also be visited individually for £5.00 each.

© All Day from 10 am

the *Old Boatyard*
SEAFOOD RESTAURANT

Harbour Centre
Arbroath
Tel 01241 879995
www.oldboatyard.co.uk

Beach Side
FAMILY RESTAURANT
IN ARBROATH

ULTIMATE EATLIST

Good Food and Good Company
ON THE SANDY SHORES OF SCOTLAND

JUNE GARDEN OPENING INFORMATION

	GARDENS	THURSDAYS 4/11/18/25	FRIDAYS 5/12/19/26	SATURDAYS 6/13/20/27
1	2 Whitewalls Farm Cottage Tealing		2-5pm	2-5pm
2	5 Glamis Place Dundee			11am-4pm
3	6 Glamis Place Dundee	9am-6pm	9am-6pm	9am-6pm
4	8 Leemount Lane Broughty Ferry	10am-4pm		
5	Balhary Walled Garden , Alyth	3-8pm	3-8pm	3-8pm
6	Damside Cottage Leysmill	10am-2pm		
7	Dundee Botanic Garden	4th only 10am-7pm	5th only 10am-7pm	6th only 10am-7pm
8	Forfar Open Garden			10am-2:30pm
9	Lawton House Inverkeilor	10am-2pm		
10	Maggie's Dundee Ninewells Hospital	anytime	anytime	anytime
11	Mains of Balgavies by Forfar	2-5pm		
12	Mildden of Stracathro		10am-2pm	
13	North Lodge Edzell		Noon-4pm	
14	Reswallie House by Forfar	2-5pm		
15	St Brides South Kingennie		1-5pm	1-5pm
16	Templeton House Garden	10am-2pm		
17	The Doocot Meigle			2-5pm

PLANT NURSERIES/GARDEN CENTRES

- Ashbrook Nursery**
Forfar Road, Arbroath DD11 3RB
9am-5:30pm
www.ashbrooknursery.co.uk
- Ferngreen Garden Centre**
Kirriemuir Road, Forfar DD8 3TG
9am-5pm
www.ferngreenc.co.uk
- Silverwells**
Montrose Road, Arbroath DD11 5RA
9am-5pm



TEAROOMS

- Dundee Botanic Garden Coffee Shop**
Riverside Drive, Dundee DD2 1QH
9am-5pm
www.dundee.ac.uk/botanic/coffeeshop/
- Edzell Tweedie**
1 Dunlappie Road, Edzell DD9 7UB
10am-5pm
www.facebook.com/edzelltweedwarehouse/
- The Joinery Coffee Shop**
The Square, Ardler Road, Meigle PH12 8RN
10am-4:15pm
www.joinerycoffeeshop.com/
- Lochlands Mill**
Dundee Road, Forfar DD8 1XF
10am-4pm
www.themillforfar.com/
- Lunan Bay Diner**
Lunan Bay, Arbroath DD11 5ST
10am - 4pm
www.facebook.com/lunanbaydiner/
- Murton Farm Tearoom & Nature Reserve**
Arbroath Road, Forfar DD9 2RZ
10am-4pm
www.murtontrust.org.uk/
- Old Boatyard**
Fishmarket Quay, Arbroath DD11 1PS (by the harbour)
10am-11pm
www.oldbotyard.co.uk
- Peel Farm Coffee Shop**
Lintrathen, Kirriemuir DD8 5JJ
10am-5pm
www.peelfarm.com
- Willows Coffee Shop**
146-148 Brook Street, Broughty Ferry DD5 1DT
8:30am-5pm
www.willowtreedundee.co.uk



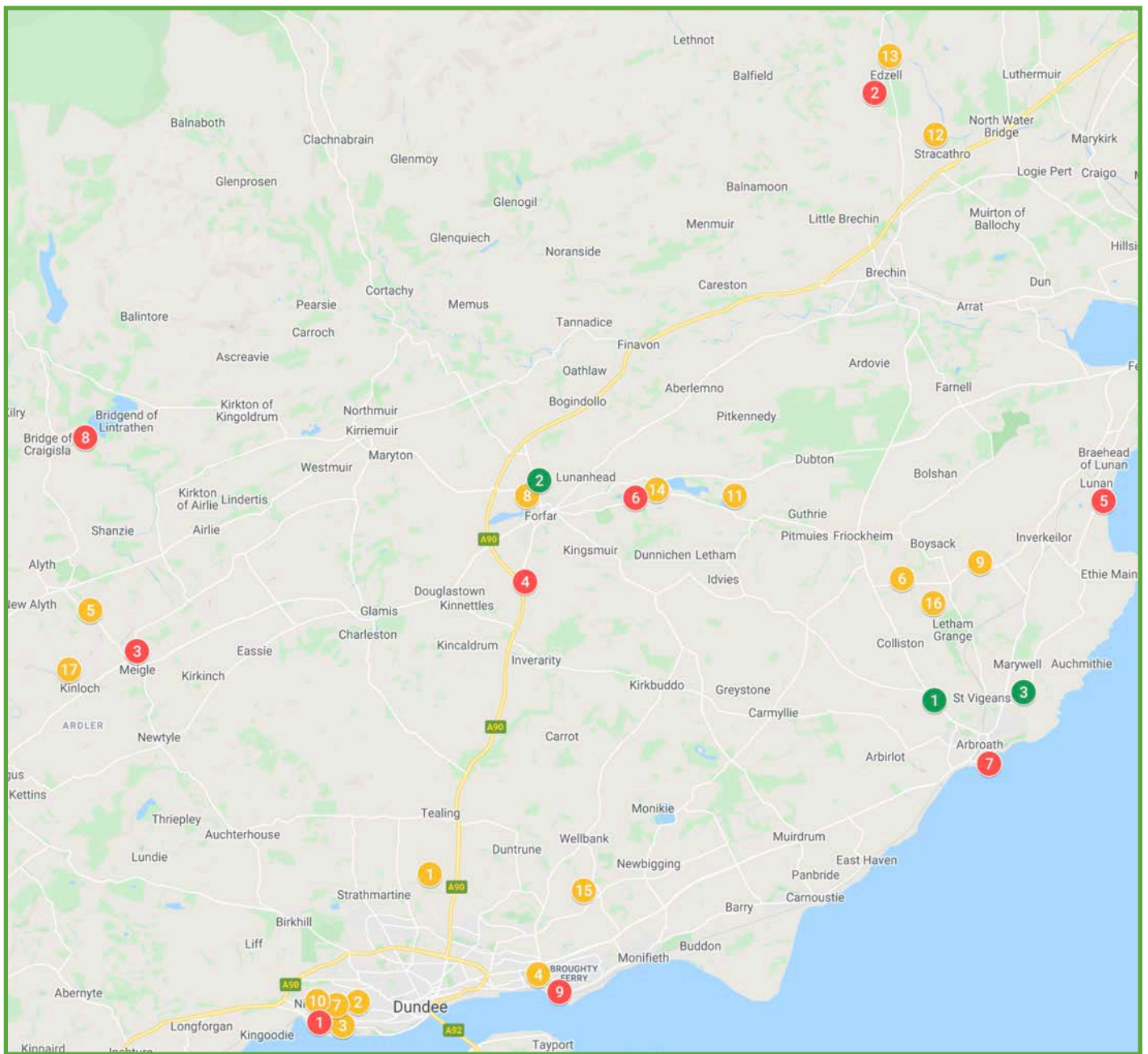

GARDENS

PLANT NURSERIES/GARDEN CENTRES

TEAROOMS



2 WHITEWALLS FARM COTTAGE

off Emmock Road, by Tealing, Dundee DD3 0QE
Tracey Williams

Whitewalls is a garden in a rural setting created by the owner over the last four years as a series of interlinked garden rooms. The garden is set in three-quarters of an acre with a range of plants and trees including acers, azaleas and rhododendrons and a large variety of perennials and shrubs, some which are unusual. The features include a Japanese-inspired garden with a Koi pond, granite lanterns and a tea house. There is a winter garden and a formal garden with long perennial border. The garden also features a wildlife pond with shade-loving plants and a stream. There is also a productive small polytunnel and fruit garden. The garden is accessible to most with a few steps and easy slopes.

Directions: Off the A90 just north of Dundee at Struan's roundabout heading towards the Black Watch memorial on Emmock Road. Emmock Road will then pass over the A90 and the garden is the first turning on the right, about two miles after the flyover. Please be aware that parking is limited and down an unadopted drive.

Open: Fridays and Saturdays in June, 2pm – 5pm



5 GLAMIS PLACE

Il Giardino de Giovanni, Dundee DD2 1NB
John Egan

Il Giardino de Giovanni is a terraced south-facing garden with excellent views. It includes a border garden, wildlife garden, and with numerous pots scattered throughout the garden along with seating.

Directions to Glamis Place: Off Glamis Terrace, off Glamis Road. Buses 73 and 22 - Blackness Road/Glamis stop and buses 5 and 16 - Perth Road and Invercarse Hotel.

Open: Saturdays in June, 11am – 4pm



6 GLAMIS PLACE

Dundee DD2 1NB
Jim and Janet Paterson

A small garden with very many interesting plants, borders around the garden walls, raised beds and planters. A variety of shrubs and small trees give structure to the underplanting of bulbs, alpines and woodland-loving plants covering all seasons. Snowdrops, corydalis erythronium in spring through summer with species paeonies, podophyllum, ferns, rosacea and much more.

Directions: Same as above.

Open: Thursdays, Fridays and Saturdays in June 9am – 6pm





8 LEEMOUNT LANE

Broughty Ferry DD5 1LA

Hannah Anthony

This is a compact residential garden secluded and sheltered by large trees. There is a pond, hens, vegetables, herbs, fruit and flowers. There is also a small chamomile lawn and mirrors are used to reflect light. The garden is ideal for young children to explore the paths, look for frogs and feed the hens and includes child-friendly vegetable labels.

Directions: The garden is at the end of the cul-de-sac, there is ample parking at the east end of Dawson Park. Grove Road bus stop on Strathern Road is nearest bus.

Open: Thursdays in June 10am – 4pm



BALHARY WALLED GARDEN

Balhary, Alyth, Blairgowrie PH11 8LT

Teri and Paul Hodge-Neale

This walled garden is being lovingly restored back to full production with the gardener's cottage gardens being transformed from concrete and grass to a magical, therapeutic hidden gem. The walled garden features 75 varieties of fruit trees lining avenues with new trees being planted. A large herbaceous border (*photo on the leaflet cover*) springs from the lavender hedges to the height of the walls. Vegetables of heritage and new varieties are grown extensively to supply 'foodies'. The cottage garden comes into its own with lighting, living flame, Zen, formal planting and a fairy garden with red squirrels frolicking about. There are quiet seating places to take in the beautiful and serene water features and sooth the soul. Tea, coffee and cake will be available to purchase.

Directions: Situated between Alyth and Meigle off the B954 opposite the sign to *Jordonstone*.

Open: Thursdays, Fridays and Saturdays in June 3pm – 8pm

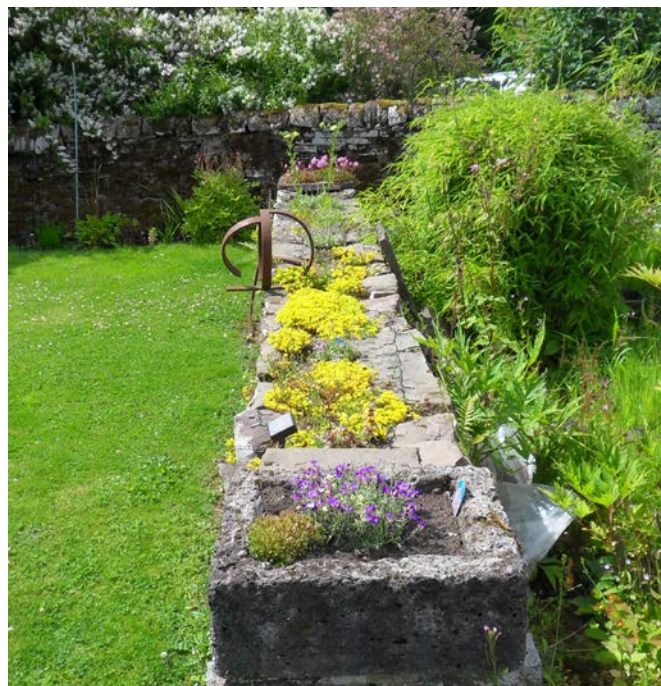

DAMSIDE COTTAGE

Leysmill, Arbroath DD11 4RR

Arthur Blair

This cottage garden is set in farmland, overlooking an old dam. It used to be two cottages and a byre and it was converted into one house. The garden once featured in early television garden shows and has evolved over the years as its owners have changed. Today the framework of the original garden remains in the abundant plantings. It is surrounded by dry stone walls and faces south. There is a small pond, area of raised beds with cutting flowers, wonderful espalier fruit trees on house walls, roses, herbaceous beds, scree planting on two low drystone walls and interesting trees. There is a beautiful example of a Tibetan cherry in the main garden.

Directions: Take Leysmill turn off from B965. Turn left at phone box. Fork left at Leysmill Farm. Continue over crossroads. *Damside* is signed on the right side of the road.

Open: Thursdays in June 10am – 2pm





DUNDEE BOTANIC GARDEN

Riverside Drive, Dundee DD2 1QH (University of Dundee)

www.dundee.ac.uk/botanic/

Visit the University of Dundee Botanic Garden and enjoy its wide range of plants, with fine collections of conifers and broad-leaved trees and shrubs, tropical and temperate glasshouses, water garden and herb garden. Located in nine-and-a-half hectares of south-facing, gently sloping land near the banks of the River Tay, the garden features many species of indigenous British plants as well as representative collections of important plants from all the continents of the world.

Directions: Situated off Riverside Drive along the Tay and on the outskirts of Dundee's City Centre. Signposted from the roundabout near Dundee's International Airport and approximately 330 yards on your right-hand side.

Open: Trail ticket holders are welcome to visit free of charge on Thursday 4th, Friday 5th June and Saturday 6th 10am - 7pm.



FORFAR OPEN GARDEN

36 Lochside Road, Forfar DD8 3JD

Forfar Open Gardeners

This is an accessible garden with a garden room and toilet facilities, situated near Forfar Loch. It is open to everyone for visits and plant sales as well as volunteering. The garden will be in its fourth growing year in 2020. We are specialising in growing herbaceous perennials. We are also developing a potager garden. The garden is at the bottom of a south-facing slope and its walls and the trees opposite make it feel peaceful. The aim of the garden is to bring people together to share skills and build connections through creating and looking after the garden. Our focus is to develop opportunities for intergenerational work and mentoring. The relationship between people and plants is at the core of what we do. There is a real well as the garden is on the site of a brewery. There is a small area of woodland with old apple and plum trees.

Directions: Situated opposite Guthrie Park, turning off the A926 opposite Tesco. Bus 117, the Town Service and Foresterseat Circular, operated by JP Minicoaches, stops outside front door.

Open: Saturdays in June 10am – 2:30pm



LAWTON HOUSE

Inverkeilor, by Arbroath DD11 4RU

Katie and Simon Dessain

The 1755 house of red sandstone is approached through beech woods and pasture. Pleached lime trees form a screen on arriving and a path laid with sets and pebble mosaic leads to the front steps, bordered by clipped hawthorn and underplanted with alliums. The borders in front of the house are a mixture of herbaceous perennials, roses and shrubs in varying shades of soft grey. In front is a lawn enclosed by a 'haha' looking onto a meadow of grazing cattle with swallows swooping low. The lawn is pierced by a Maltese flower cross planted with varying coloured stemmed dogwood, bergenias, sage and thyme which looks good in all seasons. A short walk takes you to the walled garden. This is planted with a double cross of apple, pear and plum trees, vegetables and fruit bushes quartering the garden. Two of the walls support roses and wide mixed herbaceous borders. Between the apple trees are clipped yew punctuation marks.

Directions: Take B965 between Inverkeilor and Fricockheim, turn right at sign for *Angus Chain Saws*. Drive approximately 200 yards, then take first right.

Open: Thursdays in June 10am – 2pm



MAGGIE'S DUNDEE

Ninewells Hospital, Tom McDonald Ave, Dundee DD2 1NH

www.maggiescentres.org/our-centres/maggies-dundee/

The garden at Maggie's Dundee was created in 2005, designed by the renowned landscape gardener Arabella Lennox-Boyd. The stepped earthworks act both to screen and link the building to the hospital, creating a natural amphitheatre. The centrepiece is a 33-metre labyrinth designed as a place where visitors can come to find a space for contemplation and meditation. A separate small garden, surrounded by roses and scented shrubs and plants, is set aside for private contemplation. Paths, planted with both native and more exotic trees chosen for their flower or autumn colour, make access to the centre easier. Through the design plants have been used to delight both the eye and the senses throughout the year and to complement the beauty of the building and its setting.

Directions: Located in the grounds of Ninewells Hospital, near the arboretum.

Open: The garden is available to visit at any time.



MAINS OF BALGAVIES

Forfar DD8 2TH

Georgie and Tom Sampson

The owners established a species-rich wildflower meadow, in about 2008, which has developed into a wonderful wildlife haven, particularly for butterflies and insects. There is a mass of yellow rattle, oxide daisies, varieties of vetch, broad leaf plantain and different clovers as well as some cowslips earlier in the season and later on lots of common knap weed. It is next to a small orchard which now has lots of yellow rattle under the trees. The garden has three mixed herbaceous borders around the walls and in the middle, raised beds where a variety of annuals and lots of delphiniums grow.

Directions: Take the A932 out of Forfar on the Arbroath road and after about four miles after Balgavies Loch there is a left-hand sign to *Brechin* and *Pitkenedy*. Take that left-hand turn, go over the old railway bridge and the house is the next turn on the left signed *Mains of Balgavies*.

Open: Thursdays in June 2pm – 5pm

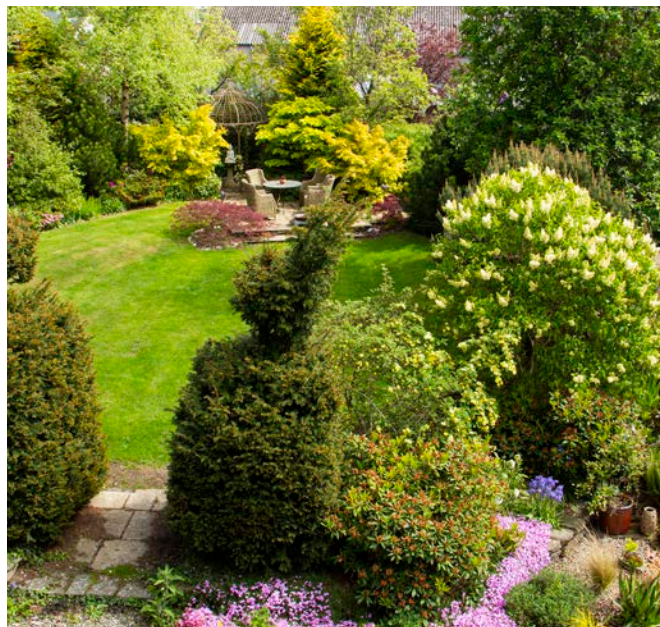

MILLDEN OF STRACATHRO

Brechin DD9 7QF

Alison and Hugh Campbell Adamson

The garden was created around twenty years ago by the present owners. It is approximately half an acre and consists of herbaceous borders surrounded by yew hedges, shrubs, a large pond and lawns running down to the bank of the Cruick river. Part of the house was the original mill building and the pond was made by opening up the mill lade again, to allow water to flow in under the bridge and back into the river under the weeping willow tree. The main part of the bridge is Victorian and was salvaged, restored and erected five years ago. There are rhododendrons and azaleas alongside mature trees and shrubs. The herbaceous borders contain a mix of perennials and roses and steps lead up to a pergola, which is covered in a mixture of honeysuckle, clematis and roses.

Directions: Take the Inchbare turn off the A90 and follow this road for about half a mile. Cross a small bridge and then with a beech hedge in front of you, turn right towards Stracathro Church. Pass the church and go through gates and follow the drive down to the house.

Open: Fridays in June 10am – 2pm



NORTH LODGE

36 Church Street, Edzell DD9 7TQ

Robin McIntosh and Paul Thomson

North Lodge was designed by James Salmon in the Arts and Crafts style and built as a summer home in 1906. The current garden was designed and planted up in the last 15 years but has grown up quickly. It is predominantly a semi-evergreen woodland garden, full of mature trees and shrubs, which act as a good backdrop for a multitude of climbers and herbaceous perennials. June is a beautiful time of year for this garden, with numerous flowering azaleas, rhododendrons and spring bulbs. The garden also has a Japanese element to it, which has been included to reflect original design features inside the house itself. Pots of acers and bamboo thrive within the protected walled environment, ferns share a shady area with our collection of snowdrops, and a still pond reflects both the sky and plants around it. Our current focus is on increasing the wildlife elements, the pond is loved by birds and a bed of plants specifically chosen for pollinators proved very successful in 2019. Red squirrels and pheasants visit regularly, and we have many varieties of nesting birds owing to the excellent number of trees, shrubs and ground cover.

Directions: Take the A90 to B966 signposted to *Edzell*. Continue through the town to the roundabout at the end and take the first exit (left) to Lethnot Road. North Lodge is on the corner of Lethnot Road and Church Street.

Open: Fridays in June noon – 4pm





RESWALLIE HOUSE

Forfar DD8 2SA

Caroline and Hugh Graham Watson

Reswallie is an attractive Georgian mansion house built in 1794 and set in pretty woodland and pasture which extends down to the shores of Rescobie Loch. There are many mature and significant tree species here including metasequoia, a pseudo-Camellia japonica, and a fine English oak planted on the south front in 1937 to commemorate the coronation of King George VI and Queen Elizabeth. The charming walled flower and vegetable gardens flank the east side of the house. The flower garden features two delightfully informal and abundant herbaceous borders with a fine collection of old-fashioned roses and delphiniums. The central pergola in the main border lends height and structure with a tumble of honeysuckle and clematis. Pebble-lined gravel pathways and an extensive Victorian greenhouse edge the borders and main lawn. The adjacent vegetable garden and orchard is neatly planted with raised beds set out between box-lined pathways. The memorial primula garden, planted in 2014 on the slopes of the main driveway, features over 40 species, as well as a significant variety of poppies and lilies. Also, of interest, are the cup and ring Pictish stones installed near the old well.

Directions: Take the A932 from Forfar and signposted to *Arbroath*. Continue about three miles and turn left signposted to *Reswallie*. Reswallie House is the first right.

Open: Thursdays in June 2pm – 5pm



ST BRIDE'S COTTAGE

South Kingennie, Broughty Ferry DD5 3PA

Alison and Donald Gordon

This half-acre garden was started from scratch in 2002 and now provides year-round interest. Planting several trees and making a wildlife pond and stream were the first priorities, as birds were sadly rare visitors to the garden. Parts of the perimeter of the garden are left semi-wild with dense shrubs to provide cover and nesting areas, while the area visible from the house is planted for viewing, with a mixture of shrubs, perennials and bulbs. Some features are inspired by visits to gardens around the world, including a Japanese-themed area with island bed. There is a small bog garden with a lovely early summer display of *Iris sibirica* and many plants justify their existence by attracting a wide variety of bees and butterflies.

Directions: From Kellas take the minor road signposted *Murroes Church* for approximately one mile to some steading houses and turn left up farm track immediately before them. St Bride's is the first house on the left with conservatory and solar panels. Alternatively from Dobbies head north on Ethiebeaton Road. Turn left at the T junction then first right signposted *Murroes Church* and the track is immediately after the steading houses. There is a sign for *St Bride's* on the low wall of the house at the bottom of the track. The postcode takes you to the steading houses if using SatNav.

Open: Fridays and Saturdays in June 1pm – 5pm





TEMPLETON HOUSE GARDEN

Arbroath DD11 4QP

Moira Coleman

This garden is set around a 15-year-old house in farmland and created in a farmyard where pigs used to live! This was a bare site and has evolved since the house was built. It is south-facing and protected by a dry-stone wall and beech hedges. It consists of a mixed border, a rose parterre with developing topiary, a raised bed vegetable and herb garden and a small orchard and fruit garden.

Directions: From the A933 running between Arbroath and Brechin, take the turn towards Leysmill. Look for the old signpost to *Templeton*. Continue on farm track for 500m through farmyard and past old farmhouse. Templeton House is then on the right, a white house with a five-bar gate.

Open: Thursdays in June 10am – 2pm



THE DOOCOT

Kinloch, Meigle, Blairgowrie PH12 8QX

Liz and George McLaren

The house and garden sit in a level two-acre site with open views to the Sidlaws and Grampians. The house is a converted 18c steading with a large doo'cot tower, completed in 2009. Garden development began in 2013 with a single row of flowering cherries and formation of two small mixed herbaceous beds, and expanded in 2014 with the creation of a parterre rose garden, and the addition of substantial shrub and herbaceous twin beds and areas of heather and hard planting including rhododendrons, azaleas and a variety of trees. In 2019 the lower half of the south garden was further developed by linking some trees and rhododendron to create seated areas and small themed beds (miniature conifers; ligularia and kniphofia; agapanthus, ferns and viburnum; astilbe and sedum; hydrangea etc) to provide interest later in the summer. The highlights in this young, varied and expanding garden are the rose garden to the front and the pink Japanese dogwood (*Cornus kousa* 'Miss Satomi') in the back garden which flowers beautifully in early summer.

Directions: Approximately two miles west of Meigle on the A94 (towards Coupar Angus). Just before the hamlet of Longleys there is a turning to the right with a small lodge with red eaves on the roadside. Turn up that tarmac road and The Doo'cot is 400 yards on the right.

Open: Saturdays in June 2pm – 5pm



OTHER GARDEN OPENINGS IN ANGUS & DUNDEE



GARDENS OPEN FOR SNOWDROPS

SATURDAY/SUNDAY, 29 FEBRUARY/1 MARCH

LANGLEY PARK GARDENS



Montrose DD10 9LG
12:00pm - 4:00pm £5.00

1 FEBRUARY - 29 FEBRUARY

DUNNINALD CASTLE



Montrose DD10 9TD
10:00am - 4:00pm £5.00

1 MARCH - 15 MARCH

LAWTON HOUSE



Inverkeilor, by Arbroath DD11 4RU
10:00am - 4:00pm £3.00

GARDENS OPEN FOR THE MAY FESTIVAL

**CELEBRATE THE MAY HOLIDAY WEEKEND 23-25 MAY
BY VISITING GARDENS ACROSS ANGUS & DUNDEE**

SATURDAY/SUNDAY/MONDAY, 23/24/25 MAY

BRECHIN MAY WEEKEND FESTIVAL



Locations across Brechin DD9 6JR
1:00pm - 5:00pm £5.00

10 MENZIESHILL ROAD



Dundee DD2 1PW
2:00pm - 5:00pm £3.00

SATURDAY/SUNDAY, 23/24 MAY

TORWOOD



Milton of Ogilvie, Glenogilvy, Glamis by Forfar DD8 1UN
2:00pm - 5:00pm £4.00

SUNDAY/MONDAY, 24/25 MAY

THE HERBALIST'S GARDEN AT LOGIE



Logie House, Kirriemuir DD8 5PN
2:00pm - 5:00pm £5.00

SUNDAY 24 MAY

INCHMILL COTTAGE



Glenprosen, near Kirriemuir DD8 4SA
2:00pm - 5:00pm £3.00

GARDENS OPEN ON SPECIFIC DATES

THURSDAYS 16 APRIL & 7 MAY

INCHMILL COTTAGE



Glenprosen, near Kirriemuir DD8 4SA
2:00pm - 5:00pm £3.00

SUNDAY 10 MAY

DALFRUIN



Kirktonhill Road, Kirriemuir DD8 4HU
2:00pm - 5:00pm £4.00

SATURDAY/SUNDAY, 16/17 MAY

GARDYNE CASTLE



by Forfar DD8 2SQ
2:00pm - 5:00pm £5.00

THURSDAYS 21 MAY, 4 JUNE & 18 JUNE

INCHMILL COTTAGE



Glenprosen, near Kirriemuir DD8 4SA
2:00pm - 5:00pm £3.00

SUNDAY 21 JUNE

ANGUS PLANT SALE



Logie Walled Garden, Kirriemuir DD8 5PN
2:00pm - 5:00pm £3.00

SATURDAY 4 JULY

ARBROATH COLLECTION OF GARDENS



Locations across Arbroath DD11 4AH
1:00pm - 5:00pm £5.00

THURSDAY 16 JULY

INCHMILL COTTAGE



Glenprosen, near Kirriemuir DD8 4SA
2:00pm - 5:00pm £3.00

SUNDAY 26 JULY

BRECHIN GARDENS IN SUMMER



Locations across Brechin DD9 6LE
12:00pm - 5:00pm £5.00

SUNDAY 2 AUGUST

MONTROSE GARDENS



Various locations across Montrose DD10 8SB
1:00pm - 5:00pm £5.00

THURSDAYS 13 AUGUST & 17 SEPTEMBER

INCHMILL COTTAGE



Glenprosen, near Kirriemuir DD8 4SA
2:00pm - 5:00pm £3.00

SATURDAY 3 OCTOBER

HOSPITALFIELD GARDENS



Hospitalfield House, Westway, Arbroath DD11 2NH
11:00am - 3:00pm £4.00

SATURDAY/SUNDAY, 17/18 OCTOBER

12 GLAMIS DRIVE



Dundee DD2 1QL £4.00

GARDENS OPEN ON A REGULAR BASIS

1 APRIL - 30 SEPTEMBER

PITMUIES GARDENS



House of Pitmuies, Guthrie, by Forfar DD8 2SN
10:00am - 5:00pm £5.00

1 MAY - 30 AUGUST (FRIDAYS, SATURDAYS & SUNDAYS)

LANGLEY PARK GARDENS



Montrose DD10 9LG
10:00am - 4:00pm £5.00

10 MAY - 31 AUGUST

DUNNINALD CASTLE



Montrose DD10 9TD
1:00pm - 5:00pm £5.00



Millden of Stracathro, part of the Angus Garden Trail

GARDENS OPEN BY ARRANGEMENT

1 JANUARY - 31 DECEMBER

TORWOOD



Milton of Ogilvie, Glenogilvy, Glamis by Forfar DD8 1UN
£4.00 T: 07988 010418 E: j.gordon.82@btinternet.com
W: www.gardendisplays.co.uk

1 APRIL - 30 SEPTEMBER

INCHMILL COTTAGE



Glenprosen, near Kirriemuir DD8 4SA
£3.00 T: 01575 540452

1 MAY - 31 MAY

10 MENZIESHILL ROAD



Dundee DD2 1PW
£3.00 T: 01382 665719

1 JUNE - 31 AUGUST

THE HERBALIST'S GARDEN AT LOGIE



Logie House, Kirriemuir DD8 5PN
£5.00 E: herbalistsgarden@gmail.com



**Your
guidebook
to some of
the finest
gardens
in Scotland**

ONLY £5 + £2 UK p&p from
SCOTLANDSGARDENS.ORG



Peel Farm, situated at the foot of Glenisla, in the beautiful Angus Glens, has much to offer. From our outstanding 4 star Visit Scotland approved self-catering cottages to our excellent Coffee Shop with its renowned reputation for delicious home-made food.

If you are just passing by why not pop into our Courtyard for a browse in the gift shop or to feed the ducks on the Mill Pond or take a stroll along the Nature Trail.

www.peelfarm.com

01575 560205 – Coffee Shop | 01575 560718 – Courtyard



Pedigree



Free Range



Traditional

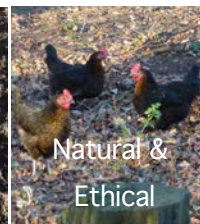

Natural & Ethical

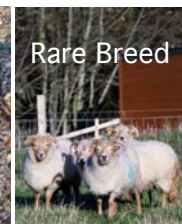

Rare Breed



Rare and Native Breeds
Produce and Conservation



Farm to Fork

Your guarantee of provenance, quality of life, sustainability, traceability and flavour



For further information or to place an order please visit www.parkhillhouse.com or call Martin & Jackie Beard on 01241 874167



The Joinery Coffee Shop

The Square, Meigle PH12 8RN



Quality Coffee • Speciality Teas • Delicious Hot Chocolate
Homemade Soups • Breakfast Rolls • Sandwiches • Panini
Baked Potatoes • Toasties • Kids' Menu • Takeaways Available

Wide selection of Home Baking
All freshly made on the premises

Gifts • Accessories • Cards
Kids' Play Area • Outside Seating
On Site Car Park

It is our pleasure to support Rising Youngstars
with their production of

Back To The 80s!

MACKAYS

FACTORY SHOP
JAMES CHALMERS ROAD,
KIRKTON INDUSTRIAL ESTATE,
ARBOATH - DD11 3LR
OPENING HOURS:
MONDAY-THURSDAY: 9AM-4.30PM
FRIDAY: 9AM-3PM

MACKAYS Made with Whole Fruit
LEMON CURD
MACKAYS Made with Whole Fruit
THE DUNDEE ORANGE MARMALADE
MACKAYS Made with Whole Fruit
SCOTTISH STRAWBERRY PRESERVE

MADE THE AUTHENTIC WAY

/MACKAYS.JAMS WWW.MACKAYS.COM

SCOTLAND'S GARDENS SCHEME

Since 1931 Scotland's Gardens Scheme has been raising money for charities, big and small, by helping open gardens of horticultural interest throughout Scotland to the public.

Many of the gardens that open under the Scotland's Gardens Scheme banner are privately owned and therefore normally inaccessible to the public. This is a fantastic opportunity to visit the gardens of Scotland whilst helping raise funds for charity.

60% of funds raised at the garden openings goes to charities of the Garden Owners' choice whilst 40% net is shared between:

- Maggie's Cancer Care Centres
- The Queen's Nursing Institute Scotland
- Perennial

More details on the gardens highlighted here, and in other districts, can be found on our website and in the Scotland's Gardens Scheme guidebook, available through the website and in leading bookshops and tourist outlets.

KEY TO SYMBOLS



Plants for sale



New garden



Homemade teas



Basic teas



Cream teas



Refreshments



Partial wheelchair access



Full wheelchair access



Dogs on leads



Children's activities



National plant collection



Champion trees



Designed landscape



Accessible by public transport



Snowdrops & Winter Walks



May festival

**TO FIND OUT MORE ABOUT US
VISIT [SCOTLANDSGARDENS.ORG](https://scotlandsgardens.org)
OR EMAIL [INFO@SCOTLANDSGARDENS.ORG](mailto:info@scotlandsgardens.org)**



**SCOTLAND'S GARDENS SCHEME
23 CASTLE STREET, EDINBURGH EH2 3BN
T: 0131 226 3714**